



RHEA
Satellite

RHEA COMPACT REMOTE COMMAND CONSOLE



USER MANUAL
RHEA Satellite Compact

CE European Electromagnetic Compatibility Directive (EMC) 2014/30/EU

WARNING

We strongly recommend that you fully read these instructions before operating the **RHEA** Satellite Compact for the first time (see section 2 – Use).

The **RHEA** Satellite Compact is a remote control screen that connects to a **RHEA** Compact device.

Read the **RHEA** Compact user manual.

To make it easier for the different users to access more detailed information, this manual is divided into 3 sections:

- **Section 1: general information.**
- **Section 2: end user instructions for use.**
- **Section 3: technical information for servicing and maintenance personnel.**

PACKING LIST

- **RHEA** Satellite Compact unit.
- Serial link cable with the **RHEA** Compact.
- User Manual.

TABLE OF CONTENTS

SECTION 1 - GENERAL INFORMATION	4
1.1 Safety instructions.....	4
1.2 Regulatory standard.....	4
1.3 Normative standards.....	4
1.4 Classification.....	4
1.5 Labelling.....	5
1.6 Physical characteristics of the RHEA Satellite Compact.....	5
1.7 Description of the device – Overview.....	6
1.8 Storage Instructions.....	7
1.9 Disposing of the unit.....	7
SECTION 2 - USE	8
2.1 Description of the installation.....	8
2.2 Description of use.....	9
2.3 Using the emergency stop button.....	9
SECTION 3 - MAINTENANCE - REPAIR	10
3.1 Cleaning.....	10
3.2 Warranty.....	10
3.3 Model identification.....	10

SECTION 1 - GENERAL INFORMATION

1.1 SAFETY INSTRUCTIONS

- **READ THESE INSTRUCTIONS THOROUGHLY** and strictly follow the chronological order of installation, start-up and maintenance.
- The device can be used up to 2,000 m in altitude with temperatures from +5°C to +35°C (41°F to 95°F) and a relative humidity of 99% non-condensing.
- Do not allow any liquid to penetrate the device.
- Do not place the device near a heat source.
- Do not use the device in the presence of flammable gases.
- Do not twist, stretch or damage the serial link cable.
- Avoid unplugging the serial link cable while in use

ATTENTION : BEFORE ANY WORK ON A **RHEA** Satellite Compact ELECTRICAL COMPONENT, UNPLUG THE SERIAL LINK CABLE.

ATTENTION : WORK ON THE **RHEA** Satellite Compact IS STRICTLY RESERVED FOR **airinspace®** MAINTENANCE STAFF OR DULY TRAINED PERSONNEL.

THE USER IS LIABLE FOR ANY DAMAGE, REGARDLESS OF ITS NATURE, CAUSED BY NON-COMPLIANCE WITH THE USAGE RULES AND SAFETY INSTRUCTIONS.

1.2 REGULATORY STANDARD

RHEA Satellite Compact devices are CE-marked and comply with European regulations



1.3 NORMATIVE STANDARDS

NF EN 61326 (2013): "Electrical equipment for measurement, control and laboratory use - EMC requirements - Part 1: general requirements"

1.4 CLASSIFICATION

Electrical protection class	Class III
Degree of protection against water and solids	IP 40

1.5 LABELLING

Label	Description	Position
Product	 <p>RHEA Satellite Compact P/N: CP17400 S/N: RHEA-SC-???? made in France airinspace™ - 14 rue Jean Monnet Elancourt 78990 - FRANCE</p>	Back of the unit

1.6 PHYSICAL CHARACTERISTICS OF THE RHEA SATELLITE COMPACT

Electrical supply	Via the interface cable linked to the RHEA Compact /+5V DC – 500 mA	
Water/solids protection index	Complete device	IP40
	Control panel	Waterproof touchscreen
Overall dimensions	H 100 x L 175 x D 60 mm	
Weight of the RHEA Satellite (excluding link cable)	350 g	
Environmental operating range	Temperature	+5 °C to +35 °C (41°F to 95°F)
	Relative humidity	< 99% non-condensing
Environmental storage range	Temperature	5°C to 35°C (41°F to 95°F)
	Relative humidity	20% to 90%
	Dust level	< 1 mg/m ³ (0.01 mg/ft ³)

NOTA : The information contained in this table is for information only. For any information on measurements and tolerance intervals, please contact **airinspace®** at the address provided at the end of this document.

1.7 DESCRIPTION OF THE DEVICE – OVERVIEW



- 1 Emergency stop button
- 2 Touchscreen
- 3 RJ45 connector

1.8 STORAGE INSTRUCTIONS

The unit must be stored in a clean area with an atmosphere not polluted by industrial activities.

The unit must be protected from dust, direct sunlight, heat sources, frequent changes in temperature and humidity, chemicals or other products.

Storage temperature: +5°C to +35°C. (41°F to 95°F)

Relative humidity: 20% to 90%.

Dust level: less than 1 mg/m³. (0.03 mg/ft³)

1.9 DISPOSING OF THE UNIT

This product is covered by European Directive 2012/19/EC dated 4 July 2012 on waste electrical and electronic equipment (WEEE) and is part of category 6. "Electrical and electronic tools (with the exception of large-scale stationary industrial tools)" as defined in annex I to this directive.



SECTION 2 - USE

2.1 DESCRIPTION OF THE INSTALLATION

The **RHEA** Satellite Compact is designed to be used with the **RHEA** Compact and requires no external power supply. Once the link between the **RHEA** Compact and the **RHEA** Satellite Compact has been established, the **RHEA** Satellite Compact acts as a remote screen, making it possible to control the **RHEA** Compact from a distance.

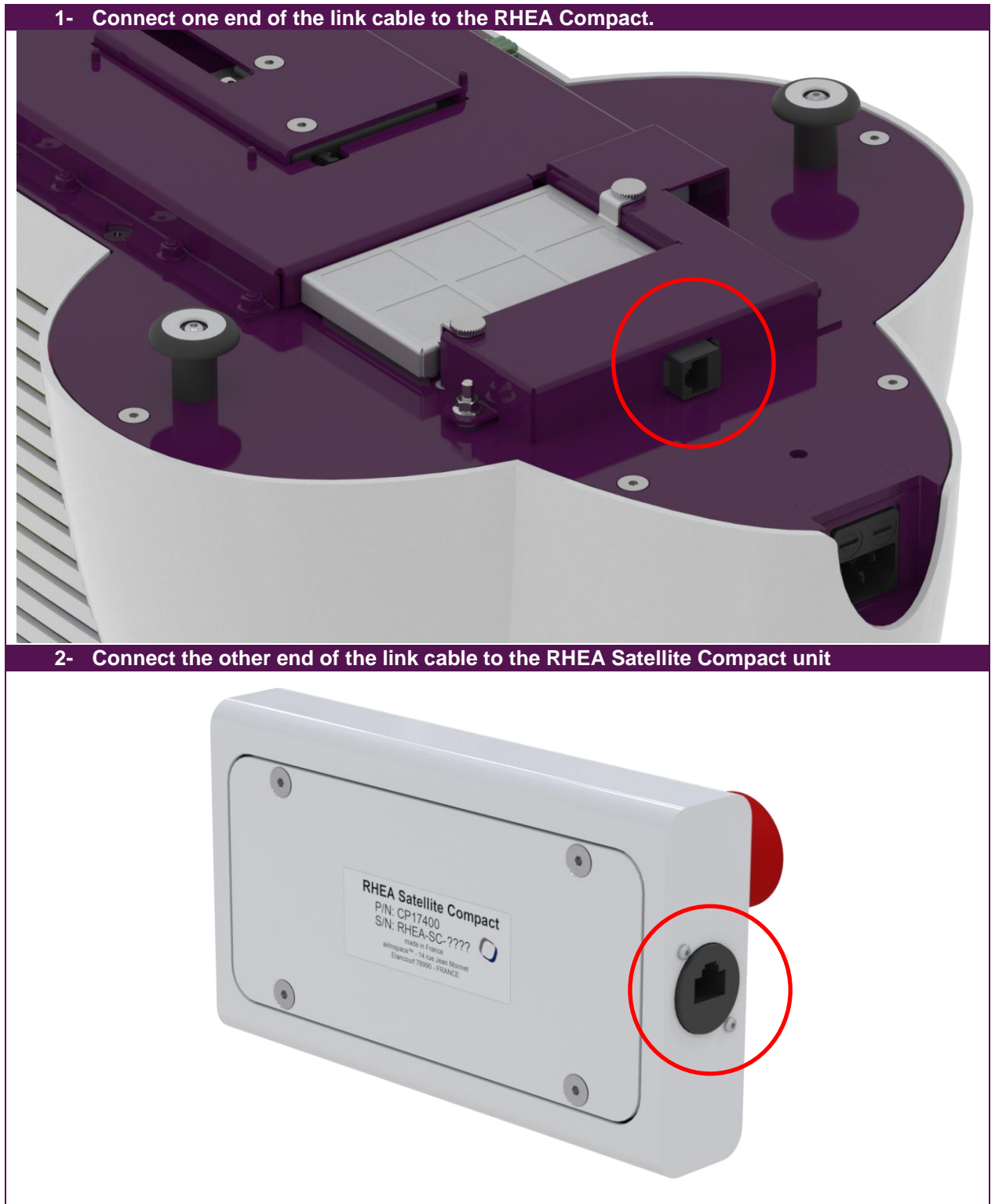

- 3- Connect the power supply cable of the RHEA Compact.
- 4- The screen of the RHEA Satellite Compact switches on; the equipment is ready for use.



2.2 DESCRIPTION OF USE

The **RHEA** Satellite Compact is connected to the **RHEA** Compact via a flat 5 m serial link cable (provided with the **RHEA** Satellite) which can slide under doors. The **RHEA** Satellite Compact is powered through this serial link cable.

This control unit allows you to configure the **RHEA** Compact from the outside via a 4.3 inch touchscreen, and monitor the progress of the disinfection cycle at any time.

The unit is also used to stop the **RHEA** Compact via the emergency stop button. The emergency stop button acts by sending information to the **RHEA** Compact controller card.

2.3 USING THE EMERGENCY STOP BUTTON

The **RHEA** Satellite is fitted with an emergency stop button that can stop the decontamination cycle at any time by pressing it.

When the emergency stop button is pressed, the **RHEA** Compact is stopped; an alarm message appears (see below).



To return to the main menu, turn the emergency stop button and place it in its initial position, then press the  icon at the bottom right of the alarm message.

SECTION 3 - MAINTENANCE - REPAIR

3.1 CLEANING

Use a single-use or recyclable wipe.

3.2 WARRANTY

Contact your local **airinspace®** dealer.

Note: any problems arising from an unauthorised repair attempt, modification, fall, use at incorrect voltage or operations that do not comply with the instructions in the User Manual are not covered by the warranty.

3.3 MODEL IDENTIFICATION

When contacting **airinspace®** or a dealer, please provide the serial number for the **RHEA** Satellite and its date of purchase:



CONTACT **airinspace®**

airinspace S.E.

14, Rue Jean Monnet
78990 Elancourt
France

☎ +33 1 30 07 01 01

📠 +33 1 30 07 01 02

contact@airinspace.com

www.airinspace.com